

**Please read the instructions
carefully before use.**

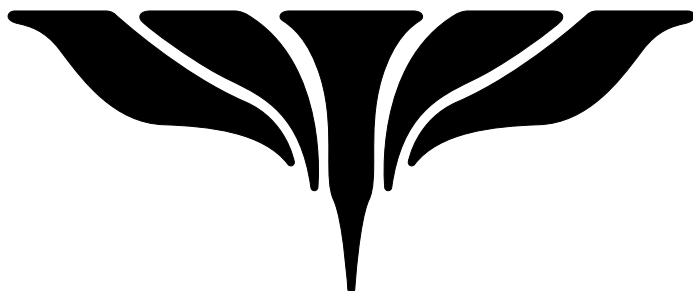

EL ROCIO
e s p r e s s o m a c h i n e

DIGNITY DUAL

DG2G-DA23

User manual

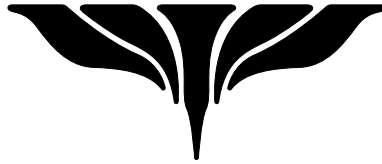

EL ROCIO
e s p r e s s o m a c h i n e

DIGNITY DUAL

1. Product Composition
2. Precautions Before Use
3. How to Use the Product
4. Settings Menu
5. Cleaning and Maintenance
6. Frequently Asked Questions

PRODUCT COMPOSITION

①

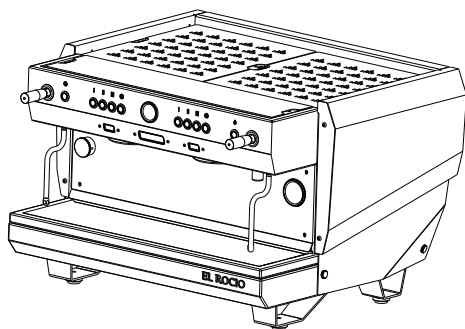

- ① Main Unit
- ② 2-Spout Portafilter x2
- ③ Bottomless Portafilter
- ④ 18g Basket x2
- ⑤ Blind Basket
- ⑥ Cleaning Brush
- Flexible Water Hose
- Drain Hose
- Tamping Mat
- Tamper
- Espresso Cup Stand

②

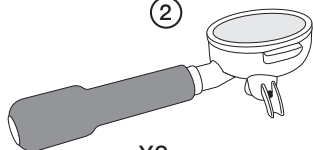

X2

③

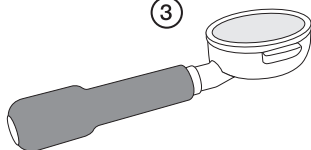

④



X2

⑤



⑥

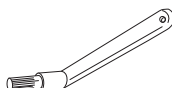

PRODUCT COMPOSITION

Name	Weight	Max Power	Dimension
DIGNITY DUAL	72Kg	5500W	618mm(D) * 755mm(W) * 492mm(H)

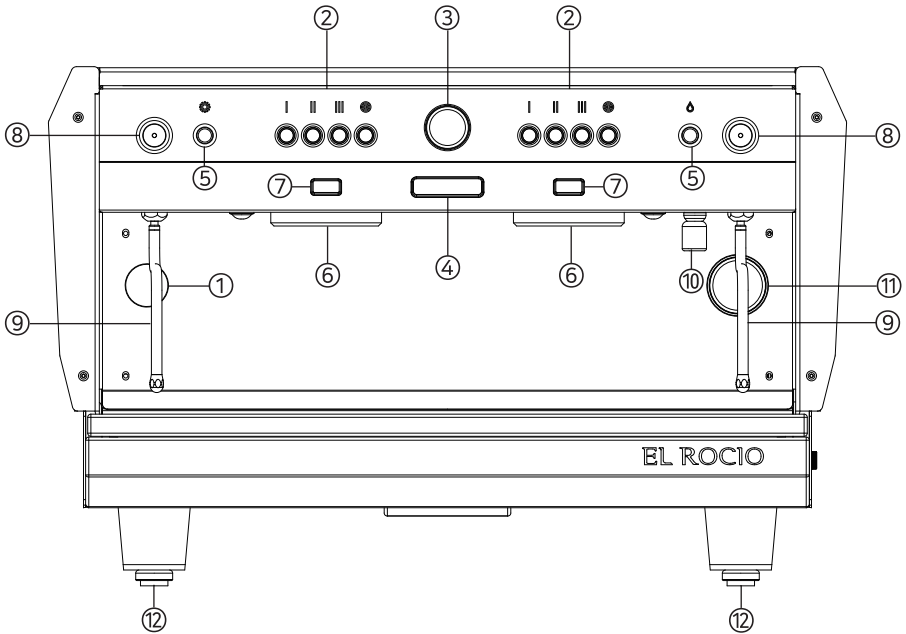

- ① Power Switch
- ② Extraction Button
- ③ Extraction Gauge
- ④ LCD Information Display
- ⑤ Settings Button / Hot Water Button
- ⑥ Group Head
- ⑦ Extraction Boiler Temperature Indicator and Extraction Timer
- ⑧ Steam Lever
- ⑨ Steam Wand
- ⑩ Hot Water Wand
- ⑪ Steam Gauge
- ⑫ Adjustable Feet

PRODUCT COMPOSITION

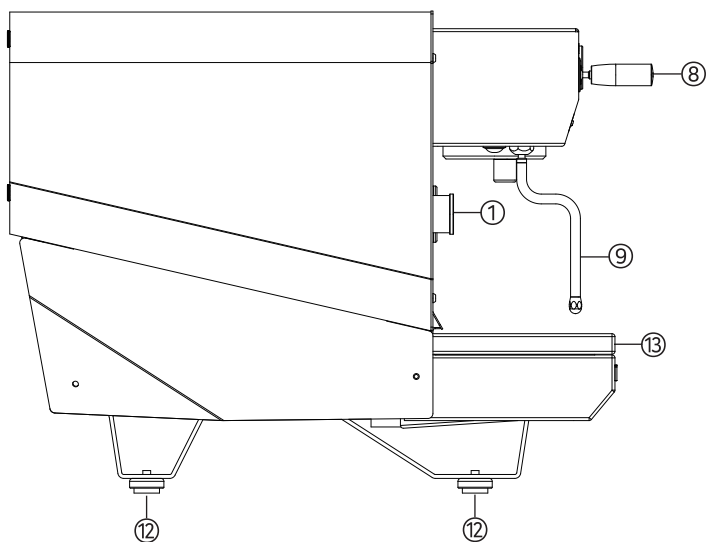

- ⑧ Steam Lever
- ⑨ Steam Wand
- ⑫ Adjustable Feet
- ⑬ Drain Tray

Precautions Before Use

Please read the instruction manual carefully before use.
 The manufacturer is not responsible for any safety accidents resulting from ignoring the precautions.

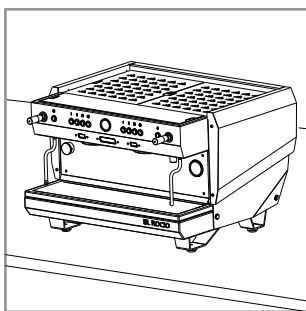

WARNING

Weight: approx. 72kg



- Install the product in a proper position.
- Use the product on a stable surface.
- When moving the product, drain the boiler and wait until both the hot water and steam boilers have completely cooled

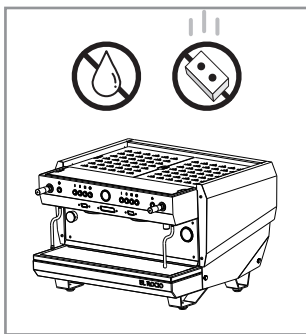

- Do not place liquids such as water or milk on the cup warmer.
- Avoid covering the product with cloths during use.

Precautions Before Use

- Unpack the product and check for damage.
- If there is any suspicion of damage or defects, do not use the product. Contact the manufacturer or place of purchase immediately.
- Keep children away from parts that may cause burns or injuries.



- Ensure the power supply matches the label before turning on the machine.
- The label can be found after removing the drain tray, on the lower left side.
- The installation site must comply with local regulations and the manufacturer's guidelines, and installation should be performed by a skilled professional.

Electrical Safety:



- The product must be installed with proper grounding for electrical safety.
- The manufacturer is not liable for any damages resulting from improper grounding.

Precautions Before Use

- Do not use the machine if you lack the necessary knowledge, experience, or training.
- Ignoring warnings may result in personal injury or damage.
- Keep sharp objects and liquids away from the power supply.



- Use a wet hand on the power switch could cause electric shock.
- The power cord must be intact and free of damage.
- Damaged cords should be replaced by the manufacturer or an authorized service technician

- During installation, use standard hoses and fittings as specified.
- The machine must be used in an environment that supports water supply. Otherwise, damage to the product may occur.

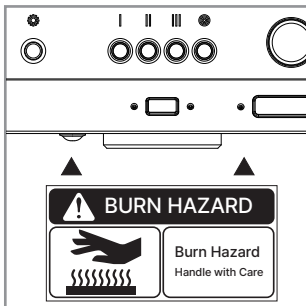

Burn Warning:

There is a risk of burns if you come into contact with heated group heads after the machine has powered on.

How to Use the Product

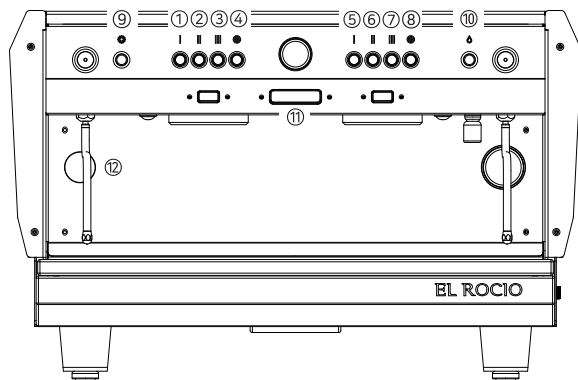

- | | |
|---|---|
| ① Extraction Switch 1 (GroupHead1) | ⑦ Extraction Switch 3 (GroupHead2) |
| ② Extraction Switch 2 (GroupHead1) | ⑧ Continuous Extraction Switch (GroupHead2) |
| ③ Extraction Switch 3 (GroupHead1) | ⑨ Set button |
| ④ Continuous Extraction Switch (GroupHead1) | ⑩ hot water button |
| ⑤ Extraction Switch 1 (GroupHead2) | ⑪ Status display |
| ⑥ Extraction Switch 2 (GroupHead2) | ⑫ Main switch |

1) Connecting the Water Supply

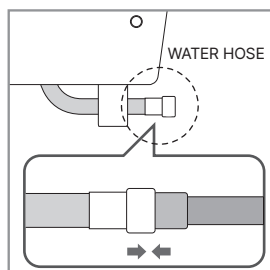

- Connect the water pump.
- Confirm the water hose at the bottom of the product.
- After ensuring the water supply connection, connect the water hose.
- If the size of the water hose differs, use a separate adapter.

How to Use the Product

2) Powering On and Preheating

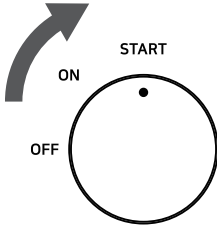

Connect the power after completing the water supply connection.

Turn on the main power switch:

1. OFF: Power off
2. ON: Water supply only
(preliminary stage; 10 minutes for boiler water level detection)
3. START: Full operation, including heating
Wait for the machine to reach the set temperature
(approximately 20–30 minutes).

3) Extracting Espresso

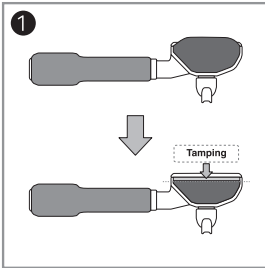

1. Fill the basket with the appropriate amount of coffee grounds and tamp with the tamper.
2. Attach the portafilter to the group head, starting at the 8 o'clock position and locking into place at 6 o'clock.
3. Press the extraction button.
4. After extraction, turn the portafilter to the left to detach.

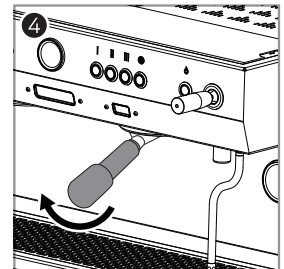
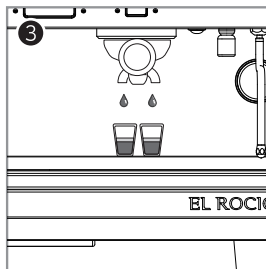
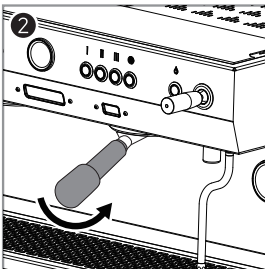

How to Use the Product

4) Using Steam

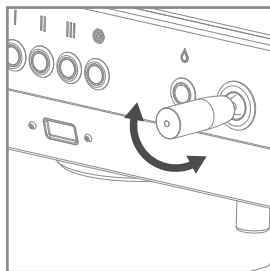

- 1 . Insert the steam wand into a pitcher with milk and adjust the steam valve.
- 2 . Use steam only after the boiler is preheated.
- 3 . The standard steam gauge pressure is 1 to 1.8 bar.
- 4 . Water condensed in the wand may discharge initially use a cloth to absorb this before starting steam.
- 5 . Once the milk reaches the desired temperature, return the lever to the original position to end steaming.

 **BURN HAZARD**

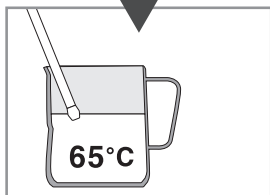
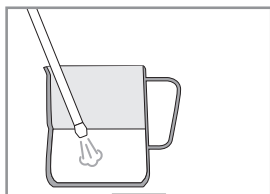



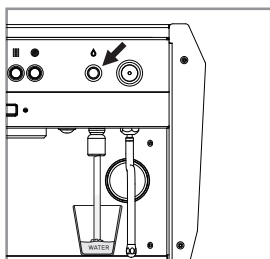

5) Using Hot Water

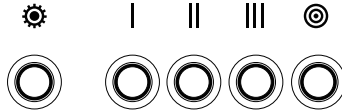

- 1 . Press the hot water button.
- 2 . Press the button again to stop after reaching the desired amount.
- 3 . Beware of burns from hot water or steam.

Settings Menu



1.  Press the button to enter the settings mode; press again to return to the home screen.
2. Use the group buttons  ,  to navigate
3.  Enter specific settings by pressing the pre-extraction button.

- Set Group Head Temperature (0–99, default 93)
- Set Brew Boiler Temperature (0–99, default 93)
- Set Steam Boiler Temperature (0–125, default 120)
- Infusion Time (0–60 sec, default 5)
- Shot Count – View and reset shot count
- Temperature Status Display (on/off)
- Flowrate Adjustment per Button
- Flowrate Copy – Copy flow settings between groups
- Water Extraction Time (3–60 sec, default 10)
- Barista Light – Adjust brightness and on/off
- Backlight – On/off
- Lock Flowrate Setting – Lock/unlock flowrate setting for extraction buttons

Settings Menu

EXTRACTION FLOW RATE SETTING

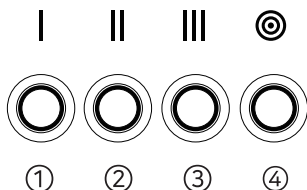

Press and hold the extraction button (①, ②, or ③) for 5 seconds to start extraction.

Release the button when the desired flowrate is reached to set the automatic flowrate.

Continuous extraction button ④ cannot have its flowrate set.

- GR 1 Inf. Time : Set pre-infusion time for Group 1
- GR 2 Inf. Time : Set pre-infusion time for Group 2
- GR 3 Inf. Time : Set pre-infusion time for Group 3

* Pressure Gauge:

Operates during extraction, with standby pressure between 9–12 bar.

LCD Display Message

- Refill the water – When refilling the steam boiler
- Coff. Extraction – When pressing the extraction button to proceed with extraction
- Flow Setting – When performing flow rate settings
- Head Cleaning – When automatic cleaning is in progress
- HEATER OFF MODE – When the power cam switch is set to position 1, heating of the boiler and group head stops
- Sensor Error – When an issue occurs with temperature sensing
- Flowtime Error – When water has not been supplied to the steam boiler for an extended time
- Shottime Error – When extraction continues for more than 10 minutes
- Cannot be set – When the flow rate setting lock function is enabled

Setting range and initial value

Temperature Setting Range

Group Head: 0–99°C (Default: 93°C)

Brew Boiler: 0–99°C (Default: 93°C)

Steam Boiler: 0–125°C (Default: 120°C)

* Note: - () initial value

Cleaning and Maintenance

1) Cleaning the Group Head

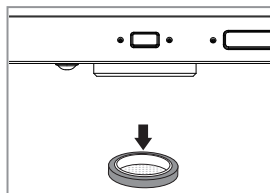

1.Remove the shower screen using a tool, being careful not to damage the group head.

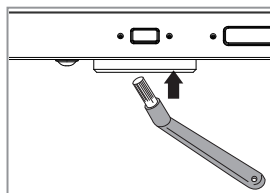

2.Use a cleaning brush to thoroughly clean inside the group head. Flush multiple times after cleaning.

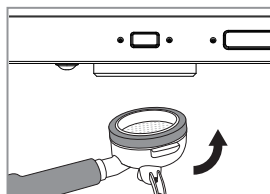

3. Reattach the shower screen using the portafilter. Ensure the rubber gasket is installed in the direction of water flow.

2) Cleaning the Drain Tray

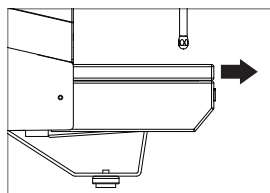

Pull the front of the drain tray slowly to remove it completely from the machine.

- Clean and reinstall in reverse order.

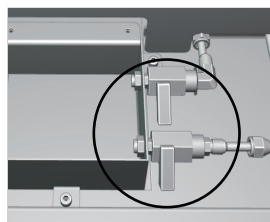

⚠ WARNING

Steam Boiler Valve & Drain Hose Maintenance:

Always ensure that the valves are perpendicular to the pipe during normal operation. Drain the boiler only when the machine is powered off and pressure is verified to be absent.

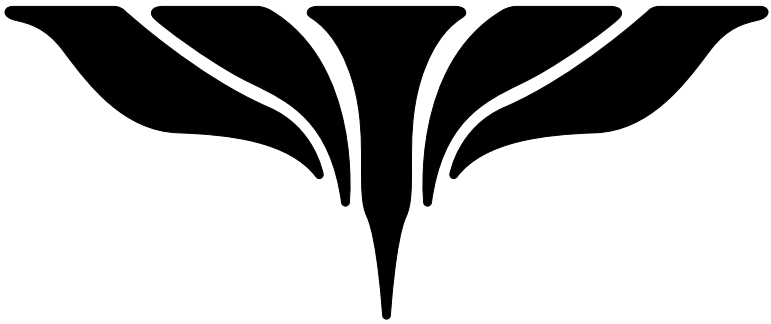

EL ROCIO
e s p r e s s o m a c h i n e

www.elrocio.co.kr